

Dimensions For API Type HR Seating Cups

Composition Cups: 275⁰ F Max Working Temperature

Plastic Cups: 300⁰ F Max Working Temperature

XT Plastic Cups: 400

Nominal Cup Size	Seating Nipple Bore	API No.	1,000s	OD	ID ₁	ID ₂	L ₄	L ₅
1-1/16	1.062		+30	1.082	0.860	0.687	0.095	0.375
1-1/4	1.250		+30	1.270	0.984	0.750	0.125	0.375
			+15	1.255		0.875		
			+30	1.270				
1-3/8	1.375		+30	1.405	1.015	0.750	0.125	0.531
			+30	1.405		0.875		
			+45	1.420				
1-1/2	1.460		-40+30	1.486	1.160	0.875	0.154	0.593
	1.500		Base	1.500				
			+15	1.515				
			+30	1.530				
			+45	1.545				
1-3/4	1.710	S18-20	-40+30	1.730	1.411	1.187	0.165	0.656
	1.750		Base	1.740				
			+15	1.755				
			+30	1.770				
			+45	1.785				
			+60	1.800				
1-25/32	1.780		Base	1.770	1.411	1.187	0.165	0.656
		S12-20	+30	1.800				
			+45	1.815				
			+60	1.830				
			+70	1.840				
1-7/8			Base	1.865	1.411	1.187	0.165	0.656
			+30	1.985				
2-1/4	2.210	S18-25	-40+30	2.230	1.850	1.562	0.185	0.0688
	2.250		Base	2.240				
			+15	2.255				
			+30	2.270				
			+45	2.285				
	2.280		+60	2.300				
S12-25		+70	2.310					
2-3/4	2.710	S18-30	-40+30	2.730	2.350	2.000	0.0185	0.688
	2.750		Base	2.740				
			+15	2.755				
			+30	2.770				
			+45	2.785				
	2.780		+60	2.800				
S12-30		+70	2.810					
3-3/4	3.750		Base	3.375	3.271	2.812	0.186	0.978
			+15	3.750				
			+30	3.765				
			+45	3.780				
			+60	3.795				

TYPE HR Seating Cup

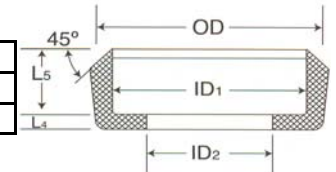

**Seating Cup Type HR Specifications
S12 Rod Pumps**

Dimensional Symbol	S12-20	S12-25	S12-30
ID ₁	+0.015/0.000	1.411	1.850
ID ₂	+0.005/0.000	1.187	1.562
OD	+/-0.005	1.800	2.310
L ₄	+0.030/-0.015	0.165	0.185
L ₅	+0.030/-0.015	0.656	0.688

**Seating Cup Type HR Specifications
S18 Tubing Pumps**

Dimensional Symbol	S18-20	S18-25	S18-30
ID ₁	+0.015/0.000	1.411	1.850
ID ₂	+0.005/0.000	1.187	1.562
OD	+/-0.005	1.730	2.230
L ₄	+0.030/-0.015	0.165	0.185
L ₅	+0.030/-0.015	0.656	0.688





Oversize Type HR Seating Cups

Nominal Cup Size	Seating Nipple Bore	1,000s	OD	ID ₁	ID ₂	L ₄	L ₅
1-1/2	1.460	-40+30	1.486	1.160	0.750	0.154	0.593
	1.500	Base	1.500				
		+15	1.515				
		+30	1.530				
		+45	1.545				
1-25/32	1.780	Base	1.770				
		+15	1.785				
		+30	1.800				
2-1/4	2.210	-40+30	2.230	1.850	1.562	0.185	0.0688
		Base	2.240				
	2.250	+15	2.255				
		+30	2.270				
		+45	2.285				
2.280	+70	2.310					
	2-3/4	Base	2.740	2.448	2.250	0.175	0.688
+30		2.770					

Working Temperatures

Plastic Seating Cups: 300F Maximum

Composition Seating Cups: 275F Maximum

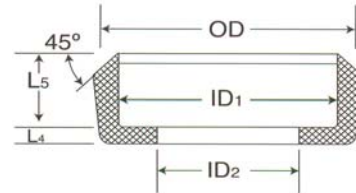

Seating Cup (Type HR) Oversized Specification

Dimensional Symbol

ID₁ +0.016/0.000

ID₂ +0.005/0.000

OD +/-0.005

L₄ +0.030/-0.015

L₅ +0.000/-0.016b

11AX-S19
11AX-S12
11AX-S18

TYPE "O" SEATING RINGS

Working Temperatures

Composition Seating Cups: 275 F Maximum

Plastic Seating Cups: 300 F Maximum

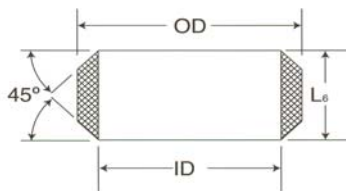

Seating Cup (Type O) 11AX-S32 Information

Dimensional Symbol	Tolerances	Part Number
OD	+/-0.005"	S32-15
ID	+0.010/-0.000"	1.188
L ₆	+/-0.031"	0.625

Nominal Cup Size	1,000s	OD	ID	L ₆
1-1/2	-10	1.490	1.188	0.625
	+30	1.530		
	+70	1.570		
1-3/4	+70	1.810	1.440	0.687
1-25/32	+30	1.800	1.425	0.687
		1.800	1.431	0.687
		1.800	1.471	0.687
		1.800	1.505	0.687
		1.800	1.560	0.687
2-1/4	+70	2.310	1.805	0.844
	+30	2.270	1.856	0.750
	+70	2.310	1.856	0.750
	+30	2.270	1.871	0.750
	+70	2.310		0.750
	+30	2.270	1.981	0.750
	+70	2.310		0.750
	+70	2.310	1.805	0.813
2-3/4	+70	2.810	2.356	0.843